

ZR TYPE

FEATURES

ZR type impeder cores have a truncated circular cross-section and are widely used in small pipes. In medium or large pipes, they can be combined to make a multiple-core impeder.

CAUTION

Please take care to only use an impeder case with an appropriate internal diameter.

The smaller impeder case of recommended internal diameter may occur not to be inserted the impeder core.

Before using this product, please note that it is not guaranteed for use as anything other than an impeder.

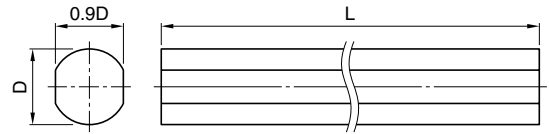

Part No. (D×L)	External diameter D	Length L	Lengthwise structure	Recommended internal diameter of impeder case
IPH ZR3×200	3±0.20	200±3.0	One piece	4
IPH ZR4×200	4±0.20	200±3.0	One piece	5
IPH ZR5×200	5±0.25	200±3.0	One piece	6
IPH ZR6×200	6±0.25	200±3.0	One piece	7
IPH ZR7×200	7±0.20	200±3.0	One piece	8
IPH ZR8×200	8±0.20	200±3.0	One piece	9
IPH ZR9×200	9±0.25	200±3.0	One piece	10
IPH ZR10×200	10±0.25	200±3.0	One piece	11
IPH ZR11×200	11±0.30	200±3.0	One piece	12
IPH ZR12×200	12±0.30	200±3.0	One piece	13
IPH ZR13×200	13±0.35	200±3.0	One piece	14
IPH ZR14×200	14±0.35	200±3.0	One piece	15
IPH ZR15×200	15±0.40	200±3.0	One piece	16
IPH ZR16×200	16±0.40	200±3.0	One piece	17
IPH ZR17×200	17±0.45	200±3.0	One piece	18
IPH ZR18×200	18±0.45	200±3.0	One piece	19
IPH ZR19×200	19±0.50	200±3.0	One piece	20
IPH ZR20×200	20±0.50	200±3.0	One piece	21
IPH ZR21×200	21±0.55	200±3.0	One piece	22
IPH ZR22×200	22±0.55	200±3.0	One piece	23

Dimensions in mm

Part No. (D×L)	External diameter D	Length L	Lengthwise structure	Recommended internal diameter of impeder case
IPH ZR23×200	23±0.60	200±3.0	2 pieces joined	24
IPH ZR24×200	24±0.60	200±3.0	2 pieces joined	25
IPH ZR25×200	25±0.65	200±3.0	2 pieces joined	26
IPH ZR26×200	26±0.65	200±3.0	2 pieces joined	27
IPH ZR27×200	27±0.70	200±3.0	8 pieces joined	28
IPH ZR28×200	28±0.70	200±3.0	8 pieces joined	29
IPH ZR29×200	29±0.75	200±3.0	8 pieces joined	30
IPH ZR30×200	30±0.75	200±3.0	8 pieces joined	31
IPH ZR35×200	35±0.90	200±3.0	10 pieces joined	37
IPH ZR40×200	40±1.00	200±3.0	10 pieces joined	42

PRODUCT IDENTIFICATION

$$\frac{\text{IPH}}{(1)} \frac{\text{ZR}}{(2)} \frac{10}{(3)} \times \frac{200}{(4)}$$

- (1) Material
- (2) Shape
- (3) External diameter D
- (4) Length L